

## Wire, Trolley, Copper, Hard Drawn, Grooved



### 1. Scope

This standard covers the requirements for grooved, hard drawn, copper trolley wire.  
This standard applies to Seattle City Light (SCL) Stock No. 610020.

### 2. Application

Wire is used by to fabricate standard (684910) and reinforced (684912) connector bars, which are used to mount fault current limiters to cutouts that have a terminal pad with a fixed position bolt.

### 3. Industry Standards

Wire shall meet the applicable requirements of the latest revision of the following industry standards:

**ASTM B 47**; Standard Specification for Copper Trolley Wire

**NEMA WC 26**; Binational Wire and Cable Packaging Standard

**RoHS**; European Union Directive 2002/95/EC for Restriction of Hazardous Substances

#### 4. Requirements

Wire shall meet the requirements of ASTM B 47 and this standard. When conflict exists, this standard shall apply.

**Figure 4. Trolley Wire Dimensions**

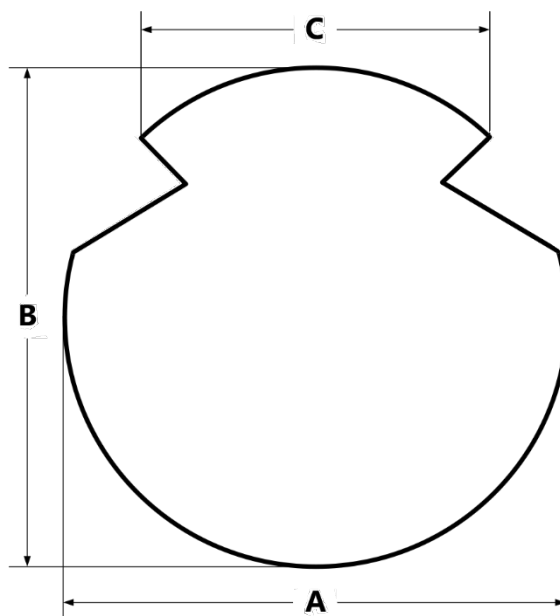

**Table 4. Wire Requirements**

Nominal Size	2/0 AWG
Breaking strength, minimum, lb	5437
Weight (lb/1000 ft)	417.4
A	0.388" (+0.006", - 0.012")
B	0.392" (+/- 0.007")
C	0.381" (+/- 0.007")

## 5. Packaging

Wire shall be packaged on 1000-foot spools to prevent damage during shipping, handling and inside storage.

Reels shall be non-returnable wood type, having a diameter of not less than 36 inch, meeting the requirements of NEMA WC 26.

Each reel shall have two each 1-1/2 inch diameter drive pin holes on each side, on a minimum radius of 6 inches.

The wire shall be adequately protected to ensure safe delivery without damage. The inner end of the wire shall be brought to the outside of the reel flange and securely fastened with steel staples appropriate to the wire size. The inner end shall not be brought out through the reel arbor. The outer end shall be fastened to the inner side of the flange with steel staples appropriate to the wire size.

Each package shall be marked with:

- Length of wire
- Weight of wire
- Wire size
- Wire type
- Manufacturer name and address
- Seattle City Light stock number

Each shipping container shall be marked with Seattle City Light purchase order number.

---

## 6. Shipping

Reels must be delivered in upright position suitable for side unloading by forklift, and not strapped or palletted.

---

## 7. Issuance

Stock Unit: FT

---

## 8. Approved Manufacturer

Manufacturer	Part No.
Service Wire Company	BGRV210CU

---

## 9. References

**Shetab, Muneer**; SCL Standards Engineer, subject matter expert and originator of 6100.50 (muneer.shetab@seattle.gov)

**SCL Material Standard 6849.1**; "Connector Bar"

**SCL Construction Standard D11-2**; "27 kV Fault Limiter Installation"

**SCL Stock Catalog Page 60-2**; June 8, 2018

<https://servicewire.com>

**Southwire Company Spec 48301**; 04/26/2019, rev. 1.1.01M